

# GENERAL MOTORS

4L60 TH700-R4 1982-92, 4L60E 1992-On

4L65E 2001-On, 4L70E 06-On

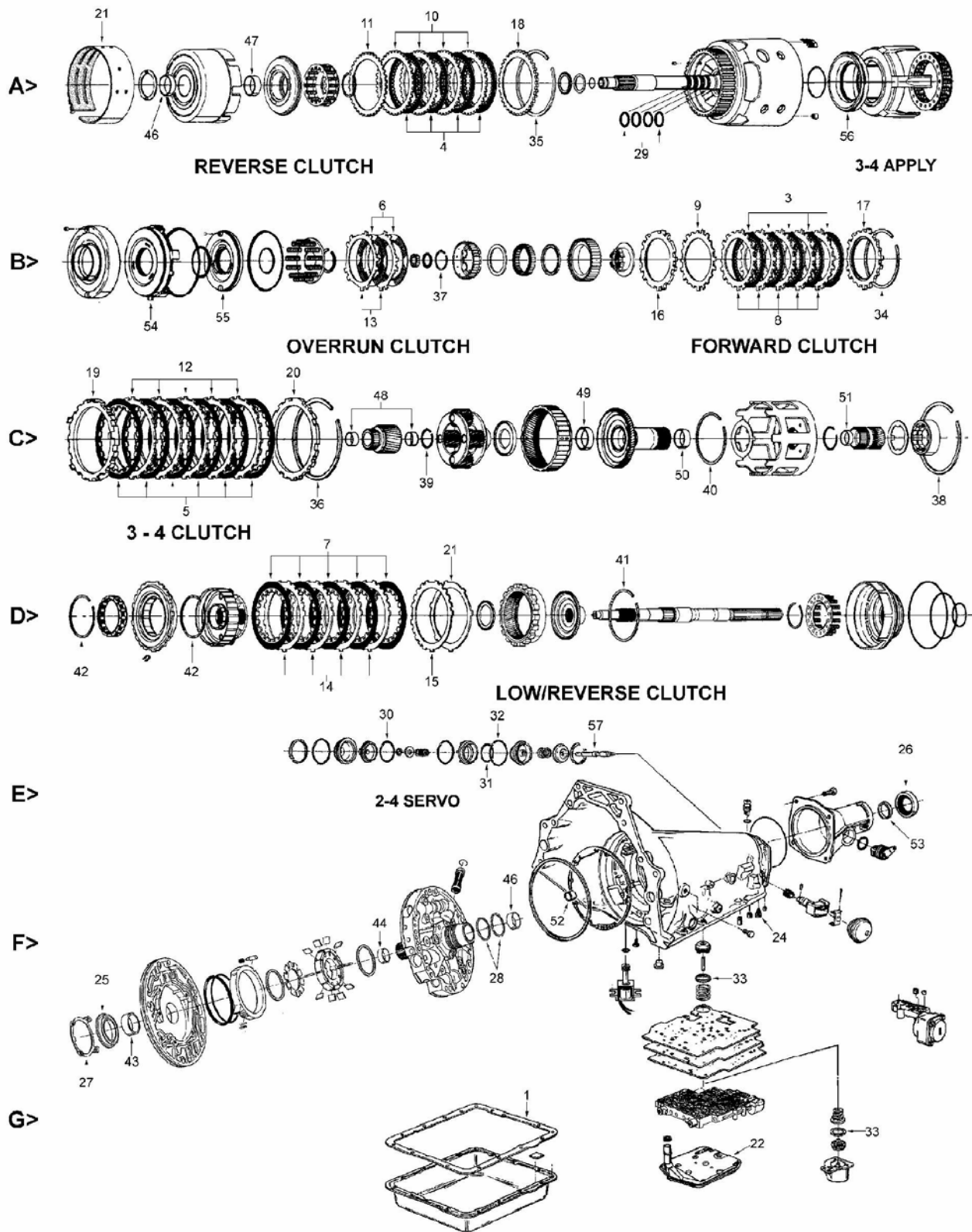

# GENERAL MOTORS

4L60 TH700-R4 1982-92, 4L60E 1992-On

4L65E 2001-On, 4L70E 06-On

## KITS

*\*Add Suffix SK for Super Kit*

ILL	Description	Years	Friction Mod	Steel Mod	Overhaul	Banner	Master
KT	Rebuilding Kit - 4L60	82-84	057752E	057753E	057800	057901LS	057901
KT	Rebuilding Kit - 4L60 with Heg Frictions	82-84	057752L	057753E	057800	057901HEGLS	057901HEG
KT	Rebuilding Kit - 4L60	85-E87	057752	057753	057800	057901ALS	057901A
KT	Rebuilding Kit - 4L60	1987	057752C	057753A	057802	NA	057907
KT	Rebuilding Kit - 4L60	87-92	057752A	057753A	057802	057901BLS	057901B
KT	Rebuilding Kit - 4L60 (combo- 4VB Gsk)	85-92	057752C	057753A	057800X	NA	057901X
KT	Rebuilding Kit - 4L60 (combo- 4VB Gsk) with Heg Fr	85-92	057752J	057753A	057800X	TBA	TBA
KT	Rebuilding Kit - 4L60E	92-1/93	057752A	057753A	057804	057905LS	057905
KT	Rebuilding Kit - 4L60E	2/93-96	057752A	057753B	057804	057905LS	057905A
KT	Rebuilding Kit - 4L60E with HEG Frictions	2/93-96	057752G	057753B	057804	057905FLS	057905F
KT	Rebuilding Kit - 4L60E with Heg Frictions, Turbulator Steels and Molded Pistons (3)	97-00	057752G	057753G	057806	057905DLS	057905D
KT	Rebuilding Kit - 4L65E with HEG Frictions (Heavy Duty) and Molded Pistons (3)	01-On	057752D	057753D	057806	057905ELS	057905E

## KITS - Specialty Kit - with PowerPack®

ILL	Description	Years	Friction Mod	Steel Mod	Overhaul	Banner	Master
KT	Rebuilding Kit - 4L60 with 3/4 PowerPack®	85-87	057750PWR FR & ST		057800	NA	057901APWR
KT	Rebuilding Kit - 4L60 with 3/4 Powerpack® and PowerBand®	85-87	057750PWR FR & ST		057800	NA	057901APWR-4
KT	Rebuilding Kit - 4L60 with 3/4 PowerPack®	87-92	057750APWR FR & ST		057802	NA	057901BPWR
KT	Rebuilding Kit - 4L60 with 3/4 PowerPack® and PowerBand®	87-92	057750APWR FR & ST		057802	NA	057901BPWR-4
KT	Rebuilding Kit - 4L60E with 3/4 PowerPack®	92-On	057750APWR FR & ST		057804	NA	057905PWR
KT	Rebuilding Kit - 4L60E with 3/4 PowerPack® and PowerBand®	92-On	057750APWR FR & ST		057804	NA	057905PWR-4

## KITS - HI-PERFORMANCE Red Eagle®

ILL	Description	Years	Friction Mod	Steel Mod	Overhaul	Banner	Master
KT	Rebuilding Kit - 4L60	82-84	057750EHP FR & ST		057800	NA	057901HP
KT	Rebuilding Kit - 4L60	85-E87	057750HP FR & ST		057800	NA	057901AHP

## KITS - HI-PERFORMANCE with PowerPack®

ILL	Description	Years	Friction Mod	Steel Mod	Overhaul	Banner	Master
KT	Rebuilding Kit - 4L60 with 3/4 PowerPack®	87-92	57750AHPPWR FR & ST		057802	NA	057901BHPPWR
KT	Rebuilding Kit - 4L60 with 3/4 PowerPack® and PowerBand®	87-92	57750AHPPWR FR & ST		057802	NA	57901BHPPWR-4
KT	Rebuilding Kit - 4L60E with 3/4 PowerPack®	92-On	57750AHPPWR FR & ST		057804 *	NA	057905HPPWR
KT	Rebuilding Kit - 4L60E with 3/4 PowerPack® and PowerBand®	92-On	57750AHPPWR FR & ST		057804 *	NA	57905HPPWR-4
	* For 1997 and On applications, Molded pistons must be ordered separately						

# GENERAL MOTORS

4L60 TH700-R4 1982-92, 4L60E 1992-On

4L65E 2001-On, 4L70E 06-On

## MISCELLANEOUS GASKETS & KIT COMPONENTS

ILL	Alto No.	Reference	Description	Spec	Year	Qty	Notes
1G	057816	8642360	Gasket, Oil Pan	Cork/Rub	82-On	1	
2F	031050A	6261413	Lathe Cut, Front Pump to case		82-On	1	
N I	010115B	6264903	O Ring, Electrical Connector		82-On	1	
N I	032003	8626281	Washer, Front Pump bolts		82-86	7	
N I	M001001	24205103	Clip, Cooler line Retainer		96-On	2	

## FRICION CLUTCHES

ILL	Alto No.	Reference	Description	Spec	Year	Qty	Notes
3B	057700	8647350	Forward	.078	82-84	5	Tan - 41T - OD: 5.310" - SM
3B	057720	8673254	Forward	.070	85-On	5	Tan - 41T - OD: 5.310" - SM
3B	057730-200	NA	Forward	.078	82-84	5	Heg - 41T - OD: 5.310" - SM
3B	057730-180	24210765	Forward	.070	85-On	5	Heg - 41T - OD: 5.310" - SM
4A	057702	8654306	Reverse Input	.078	82-87	4	Tan - 41T - OD: 6.039" - PL
4A	057712	8673605	Reverse Input	.070	87-On	4	Tan - 41T - OD: 6.039" - PL
4A	057732-200	NA	Reverse Input	.078	82-87	4	Heg - 41T - OD: 6.039" - PL
4A	057732-180	NA	Reverse Input	.070	87-On	4	Heg - 41T - OD: 6.039" - PL
5C	057704	8679390	3/4 Clutch	.080	82-On	6	Tan - 20T - OD: 5.742" - SM
5C	057704A	NA	3/4 Clutch - PowerPack® Component	.062	82-On	AR	Tan - 20T - OD: 5.742" - SM
5C	057734-200	NA	3/4 Clutch	.080	82-00	6	Heg - 20T - OD: 5.742" - SM
5C	057734-168	24237477	3/4 Clutch - 4L65E hardened spline	.066	01-On	7	Heg - 20T - OD: 5.742" - SM
5C	057734-158	24216932	3/4 Clutch - PowerPack® Component	.062	82-On	AR	Heg - 20T - OD: 5.742" - SM
6B	057706	8673253	Overrun	.075	82-On	2	Tan - 36T - OD: 5.037" - PL
6B	057736-200	NA	Overrun	.078	82-On	2	Heg - 36T - OD: 5.037" - PL
7D	057708	24216946	Low/Reverse	.087	82-On	5	Tan - 25T - OD: 6.461" - SM
7D	057708A220	NA	Low/Reverse	.087	82-On	5	Tan - 25T - OD: 6.461" - WF
7D	057738-220	NA	Low/Reverse	.087	82-On	5	Heg - 25T - OD: 6.461" - PL
N I	171700-170	88935701	Transfer Case (NVG 125C, 225C) 1sided-Int. Spline	.067/1.7	02-On	9	Heg - 50T - SB
N I	171701-170	88935700	Transfer Case (NVG 125C, 225C) 1sided-Ext. Spline	.067/1.7	02-On	9	Heg - 16T - SB
N I	126700	12547607	Transfer Case (NVG 136, 236)	.087	98-On	8-10	Heg - 54T - OD: 6.080" - SM

## FRICION CLUTCHES - HI-PERFORMANCE - Red Eagle®

ILL	Alto No.	Reference	Description	Spec	Year	Qty	Notes
3B	057740	NA	Forward (Hardened Spline)	.078	82-84	5	Red Eagle®
3B	057740A	NA	Forward (Hardened Spline)	.070	85-On	5	Red Eagle®
4A	057742	NA	Reverse Input	.078	82-87	4	Red Eagle®
4A	057742A	NA	Reverse Input	.070	87-On	4	Red Eagle®
5C	057744	NA	3/4 Clutch	.080	82-On	6	Red Eagle®
5C	057744A	NA	3/4 Clutch - PowerPack® Component	.062	82-On	AR	Red Eagle®
6B	057746	NA	Overrun	.075	82-On	2	Red Eagle®
7D	057748	NA	Low/Reverse	.087	82-On	5	Red Eagle®

## FRICION CLUTCHES - HI-PERFORMANCE - UNIT PACKS (ONE Rebuild)

ILL	Alto No.	Reference	Description	Spec	Year	Qty	Notes
KT	057740UP5	NA	Forward	.078	82-84	1	5 Red Eagle® Frictions
KT	057740AUP5	NA	Forward	.070	85-On	1	5 Red Eagle® Frictions
KT	057742UP4	NA	Reverse Input	.078	82-87	1	4 Red Eagle® Frictions
KT	057742AUP4	NA	Reverse Input	.070	87-On	1	4 Red Eagle® Frictions
KT	057744UP6	NA	3/4 Clutch	.080	82-On	1	6 Red Eagle® Frictions
KT	057744AUP9	NA	3/4 Clutch - PowerPack® Component	.062	82-On	1	9 Red Eagle® Frictions
KT	057746UP2	NA	Overrun	.075	82-On	1	2 Red Eagle® Friction
KT	057748UP5	NA	Low/Reverse	.087	82-On	1	5 Red Eagle® Frictions

# GENERAL MOTORS

4L60 TH700-R4 1982-92, 4L60E 1992-On

4L65E 2001-On, 4L70E 06-On

## STEEL CLUTCHES

ILL	Alto No.	Reference	Description	Spec	Year	Qty	Notes
8B	057701	8642167	Forward	.078	82-84	4	20T - ID: 4.257"
8B	057721	8654325	Forward	.090	85-On	4-5	20T - ID: 4.257"
8B	057717	8642711	Forward - 6 cylinder engines	.078	82-86	1	10T - ID: 4.257"
9B	057729	8647058	Forward - wave	.069	84-3/95	1	20T - ID: 4.257"
9B	057729A	24203903	Forward - wave	.069	4/95-On	AR	12T - ID: 4.257"
9B	057729A110	8685050	Forward - wave	.044	94-On	AR	12T - ID: 4.257"
9B	057729A130	8686010	Forward - wave	.052	94-On	AR	12T - ID: 4.257"
10A	057703	8673601	Reverse Input	.078	82-On	3-4	36T - ID: 5.084"
10A	057703H	24205267	Reverse Input with Turbulator Holes	.078	82-On	3-4	36T - ID: 5.084"
10A	057703-230	NA	Reverse Input - oversize	.090	82-On	AR	36T - ID: 5.084"
10A	057703H230	NA	Reverse Input - oversize with Turbulator Holes	.090	82-On	AR	36T - ID: 5.084"
11A	057711	8642060	Reverse Input - wave	.088	82-83	1	36T - ID: 5.084"
11A	057731	8647067	Reverse Input - wave	.080	84-87	1	36T - ID: 5.084"
11A	057766	8663074	Reverse Input - dish	.091	87-On	AR	36T - ID: 5.084"
11A	057766-130	8685893	Reverse Input - dish	.051	88-On	AR	36T - ID: 5.084"
11A	057703A089	NA	DrumSaver® - reverse input		87-On	1	
11A	057766-180	8685892	Reverse Input - dish	.071	88-On	AR	36T - ID: 5.084"
12C	057705	8678054	3/4 Clutch (1987-92 = 1)	.077	82-92	5/1	15T - ID: 4.995"
12C	057725	8678053	3/4 Clutch with notch (does retro)	.076	82-1/93	5	20T - ID: 4.995"
12C	057725-270	8685045	3/4 Clutch	.106	1/93-On	5	20T - ID: 4.995"
12C	057725-300	NA	3/4 Clutch - selective	.118	82-On	5	20T - ID: 4.995"
12C	057725A270	8685045	3/4 Clutch - OE surface finish	.106	1/93-On	5	20T - ID: 4.995"
12C	057725A242	24216939	3/4 Clutch -OE surface finish	.095	01-On	6	20T - ID: 4.995"
12C	057725A	NA	3/4 Clutch - PowerPack® Component	.060	82-On	AR	20T - ID: 4.995"
13B	057707	8642154	Overrun	.092	82-On	2	10T - ID: 4.262"
14D	032701	8680439	Low/Reverse	.068	82-On	5	17T - ID: 5.727"
14D	032701H	24205268	Low/Reverse with Turbulator Holes	.068	82-On	5	17T - ID: 5.727"
21D	057761	8676362	Low/Reverse - wave	.095	87-On	1	17T - ID: 5.727"
NI	126701	12547608	Transfer Case (NVG 136, 236)	.067	98-On	8-9	12T - ID: 5.023"

## STEEL CLUTCHES - HI-PERFORMANCE - Kolene®

ILL	Alto No.	Reference	Description	Spec	Year	Qty	Notes
8B	057701K	NA	Forward	.078	82-84	4	20T - ID: 4.257"
8B	057721K	NA	Forward	.090	85-On	4-5	20T - ID: 4.257"
10A	057703K	NA	Reverse Input	.078	82-On	3-4	36T - ID: 5.084"
10A	057703HK	NA	Reverse Input with Turbulator Holes	.078	82-On	3-4	36T - ID: 5.084"
12C	057725K	NA	3/4 Clutch	.076	82-1/93	5	20T - ID: 4.995"
12C	057725K270	NA	3/4 Clutch	.106	1/93-On	5	20T - ID: 4.995"
12C	057725AK	NA	3/4 Clutch - PowerPack® Component	.060	82-On	AR	20T - ID: 4.995"
13B	057707K	NA	Overrun	.092	82-On	2	10T - ID: 4.262"
14D	032701K	NA	Low/Reverse	.068	82-On	5	17T - ID: 5.727"
14D	032701HK	NA	Low/Reverse with Turbulator Holes	.068	69-86	5	17T - ID: 5.727"

## STEEL CLUTCHES - HI-PERFORMANCE - UNIT PACKS (ONE Rebuild)

ILL	Alto No.	Reference	Description	Spec	Year	Qty	Notes
KT	057701KUP4	NA	UNIT PACK - Forward	.078	82-84	1	4 Kolene® Steels
KT	057721KUP5	NA	UNIT PACK - Forward	.090	85-On	1	5 Kolene® Steels
KT	057703KUP4	NA	UNIT PACK - Reverse Input	.078	82-On	1	4 Kolene® Steels
KT	057703HKUP4	NA	UNIT PACK - Reverse Input with Turbulator Holes	.078	82-95	1	4 Kolene® Steels
KT	057725KUP5	NA	UNIT PACK - 3/4 Clutch	.076	82-1/93	1	5 Kolene® Steels
KT	057725AKUP10	NA	UNIT PACK - 3/4 Clutch PowerPack® Comp	.060	82-On	1	10 Kolene® Steel
KT	057713UP1	NA	UNIT PACK - 3/4 Clutch PowerPack® Comp	.128	82-On	1	1 Pressure Plate
KT	057707KUP2	NA	UNIT PACK - Overrun	.092	82-On	1	2 Kolene® Steels
KT	032701KUP5	NA	UNIT PACK - Low/Reverse	.068	82-On	1	5 Kolene® Steels
KT	032701HKUP5	NA	UNIT PACK - Low/Reverse with Turbulator Holes	.068	69-86	1	5 Kolene® Steels

# GENERAL MOTORS

4L60 TH700-R4 1982-92, 4L60E 1992-On

4L65E 2001-On, 4L70E 06-On

## PRESSURE PLATES

ILL	Alto No.	Reference	Description	Spec	Year	Qty	Notes
16B	TBA	NA	Forward - apply	.250	82-86	1	
16B	057760K	8682866	Forward - apply	.170	87-On	1	
17B	057760-675	8642169	Forward - backing	.265	82-86	AR	
17B	057760A947	8682867	Forward - backing (A)	.275	87-On	AR	
17B	057760A898	8682868	Forward - backing (B)	.253	87-On	AR	
17B	057760A829	8682869	Forward - backing (C)	.229	87-On	AR	
17B	057760A770	8682870	Forward - backing (D)	.205	87-On	AR	
17B	057760A462	8682871	Forward - backing (E)	.182	87-On	AR	
18A	057761-630	8663654	Reverse Input - backing	.250	82-86	1	
18A	057761-752	8682863	Reverse Input - backing	.296	87-On	AR	
18A	057761-660	8682864	Reverse Input - backing	.269	87-On	AR	
18A	057761-600	8682865	Reverse Input - backing	.218	87-On	AR	
19C	057713	8642172	3/4 Clutch - apply	.128	82-89	1	
19C	TBA	8685044	3/4 Clutch - apply	.218	90-On	1	
20C	057764-700	8642621	3/4 Clutch - backing (#1)	.280	82-86	AR	
20C	057764-600	8642622	3/4 Clutch - backing (#2)	.241	82-86	AR	
20C	057764A500	8642623	3/4 Clutch - backing (#3)	.202	82-86	AR	
20C	057764A400	8642624	3/4 Clutch - backing (#4)	.163	82-86	AR	
20C	057764A650	8667535	3/4 Clutch - backing	.255	87-93	AR	
20C	057764A564	8667536	3/4 Clutch - backing	.222	87-93	AR	
20C	057764A483	8667537	3/4 Clutch - backing	.190	87-93	AR	
20C	057764A399	8667538	3/4 Clutch - backing	.157	87-93	AR	
20C	057764B584	8685046	3/4 Clutch - backing (A)	.230	91-On	AR	
20C	057764-490	8685047	3/4 Clutch - backing (B)	.193	93-On	AR	
20C	057764B406	8685048	3/4 Clutch - backing (C)	.160	91-On	AR	
15D	057719B	8667584	Low/Reverse - Spacer	.094	87	AR	17T - ID: 5.727"
15D	057719C	8667585	Low/Reverse - Spacer	.125	87	AR	17T - ID: 5.727"
15D	057719D	8680440	Low/Reverse - Spacer	.049	88-On	AR	17T - ID: 5.727"
15D	057719DH	24205269	Low/Reverse - Spacer with Turb. Holes	.049	99-On	AR	17T - ID: 5.727"
15D	057719E	8680441	Low/Reverse - Spacer	.089	88-On	AR	17T - ID: 5.727"
15D	057719EH	NA	Low/Reverse - Spacer with Turb. Holes	.089	99-On	AR	17T - ID: 5.727"

## OEI® Original Equipment Improvements

ILL	Alto No.	Reference	Description	Spec	Year	Qty	Notes
KT	057757B	NA	3/4 Clutch PowerPack®		82-On	1	Higher clutch capacity
KT	057757BHP	NA	3/4 Clutch PowerPack® - HI PERFORMANCE		82-On	1	
KT	057757C	NA	3/4 Clutch HEG PowerPack®		82-On	1	
KT	057758	NA	DrumSaver® Kit - Reverse Input		87-On	1	
57E	057301	NA	Servo Pin - Modified (extended)		82-On	1	Extended for better band adjustability
N I	057750PS	NA	OEI® Kit 4L60, 4L60E - Friction/Steel Module contains 3/4 PowerPack®, Seal Retainer & Carbonite® Band		82-On	1	
KT	057985	SK® 700	Shift Kit® - 4L60	Transgo®	82-93	1	
KT	057986	SK® 700JR	Shift Kit® JRT - 4L60	Transgo®	82-93	1	
KT	057987	SK® 4L60E	Shift Kit® - 4L60E	Transgo®	92-On	1	
KT	057988	700-2&3	Reprogramming Kit™	Transgo®	82-On	1	
KT	057991	4L60E-HD2	Reprogramming Kit™	Transgo®	92-On	1	Heavy Duty
KT	057991A	4L60E-3	Reprogramming Kit™	Transgo®	92-On	1	Racing

## BANDS

ILL	Alto No.	Reference	Description	Spec	Year	Qty	Notes
21A	057950	24201131	2-4 Intermediate	Tan	82-On	1	



# GENERAL MOTORS

4L60 TH700-R4 1982-92, 4L60E 1992-On

4L65E 2001-On, 4L70E 06-On

*BANDS - HI-PERFORMANCE - Red Eagle® or Carbonite®*

ILL	Alto No.	Reference	Description	Spec	Year	Qty	Notes
21A	057960	NA	2-4 Intermediate - Heavy Duty	Red	82-On	1	Red Eagle®
21A	057950C	NA	2-4 Intermediate - Super Duty	Crb	82-On	1	Carbonite®
21A	057960C	NA	2-4 Intermediate - Super Duty with Reinforced Anchors	Crb	82-On	1	Carbonite®
21A	057961	NA	2-4 Intermediate - Heavy Duty PowerBand®	Red	82-On	1	Red Eagle®
21A	057961C	NA	2-4 Intermediate - Super Duty PowerBand®	Crb	82-On	1	Carbonite®

## FILTERS ( add Prefix FK for FILTER KIT )

ILL	Alto No.	Reference	Description	Spec	Year	Qty	Notes
22G	057940	8667689	Filter - 4L60, TH700-R4		82-93	1	
22G	057942	8685774	Filter - 4L60E		92-96	1	
22G	057944	24208149	Filter - 4L60E - Corvette		97-On	1	
22G	057946	24208576	Filter - 4L60E - Truck (2 7/8" thick) all 4WD, Van		98-On	1	
22G	057946A	24208813	Filter - 4L60E - deep pan light truck, retro fit all 4WD, Van		98-On	1	plastic
22G	057946B	24225323	Filter - 4L60E, 4L65E Chevy Truck, Colorado, Canyon		04-On	1	
22G	057942	8685774	Filter - 4L60E - Car (2 1/4" thick)		97-On	1	
23F	057551	8642912	Screen - Pump Cover		82-On	1	
24F	057552	12338044	Screen - TCC & Governor feed		82-On	1	

## METAL CLAD SEALS

ILL	Alto No.	Reference	Description	Spec	Year	Qty	Notes
25F	043400	24202535	Front Pump	Vamac®	82-On	1	
26E	032402	8673526	Extension Housing - Flange / No boot		82-On	1	
26E	057405	24201470	Extension Housing - Flange / with boot		94-On	1	
26E	057406	24207010	Extension Housing - Corvette		97-On	1	
N I	032410C	8623056	Manual Lever		82-On	1	
27F	057501	8654491	Front Pump seal retainer		82-On	1	

## SEALING RINGS

ILL	Alto No.	Reference	Description	Spec	Year	Qty	Notes
KT	057600	C355	Sealing Ring Kit, 4L60 - 19T		82-92	1	
KT	057601	C377	Sealing Ring Kit, 4L60E - 11T		92-On	1	
KT	057602	NA	Sealing Ring Kit - servo D-Ring (5)		82-On	1	
28F	043100	8628055	Stator Support - scarf cut		82-92	2	
28F	043100A	8681292	Stator Support - solid		92-On	2	
29A	057100	8667035	Turbine Shaft - solid		82-On	4	
30E	057105	8642480	4th Apply piston - outer		82-On	1	
31E	057103	8642458	2nd Apply piston - inner	2.324	82-On	1	
31E	057102	8642084	2nd Apply piston - inner	1.804	82-On	1	
31E	057103A	8642459	2nd Apply piston - inner	2.530	82-On	1	
32E	057104	8642081	2nd Apply piston - outer		82-On	1	
33F	043117	8634161	3-4 / 1-2 Accumulator piston		82-92	2	
N I	043115	8630120	2nd Servo pin		82-On	2	

## SNAP RINGS

ILL	Alto No.	Reference	Description	Spec	Year	Qty	Notes
KT	057680	NA	Snap Ring Kit		82-On	1	
34B	057255	8642170	Forward Clutch drum		82-On	1	
35A	057252	8667022	Reverse Input Drum		82-On	1	
36C	057254-128	8642177	3/4 Clutch Drum	.128	82-86	1	
36C	057254-093	8663636	3/4 Clutch Drum	.093	87-On	1	
36C	057254-062	NA	3/4 Clutch Drum - Selective	.062	87-On	AR	
37B	057251	8647083	Overrun Clutch hub retainer		82-On	1	
38C	057256	24200278	Low/Reverse Support retainer		82-On	1	
39C	057253	8654141	Output shaft to Input Planet		82-On	1	

## GENERAL MOTORS

4L60 TH700-R4 1982-92, 4L60E 1992-On

4L65E 2001-On, 4L70E 06-On

### SNAP RINGS

ILL	Alto No.	Reference	Description	Spec	Year	Qty	Notes
40C	057257	8642201	Reaction shaft to Internal gear retainer		82-On	1	
41D	057258	8642220	Reaction gear to Support		82-On	1	
41D	057258HD	8642220HD	Reaction gear to Support - Heavy Duty		82-On	1	
42D	032252	6261051	Low/Reverse overrun clutch		82-On	2	

### BUSHINGS

ILL	Alto No.	Reference	Description	Spec	Year	Qty	Notes
KT	057625	NA	Bushing Kit - 30 spline		84-On	1	
43F	057200	24206030	Front Pump Body	Bronze	82-On	1	
43F	057200A	8687987	Front Pump Body	Babbitt	82-On	1	
44F	043201	8628915	Front Pump Stator - Front	27 spline	82-84	1	
44F	032212	8647954	Front Pump Stator - Front	30 spline	84-On	1	
45F	057202	8642904	Front Pump Stator - Rear		82-On	1	
46A	057204	8647035	Reverse Input drum - Front		82-On	1	
47A	043204	8628917	Reverse Input drum - Rear		82-On	1	
48C	057205	8642181	Input Sun gear - Front & Rear		82-On	2	
49C	057206	8642908	Reaction Carrier Shaft - Front		82-On	1	
50C	057207	8642907	Reaction Carrier Shaft - Rear		82-On	1	
51C	057208	8642909	Reaction Sun Gear		82-On	1	
52F	032207	8641118	Case	Babbitt	82-On	1	
52F	032207A	8680027	Case	Bronze	82-On	1	
53E	032208	6260048	Extension Housing	Bronze	82-On	1	
53E	032208A	3717682	Extension Housing	Babbitt	82-On	1	

### WASHERS

ILL	Alto No.	Reference	Description	Spec	Year	Qty	Notes
KT	057635	NA	Washer Kit		82-On	1	

### MISCELLANEOUS

ILL	Alto No.	Reference	Description	Spec	Year	Qty	Notes
NI	057315	24203265	Bolt, Bell Housing to Case - Torx Plus®	M10	82-On	8	Does Retro-fit
KT	057315UP8	NA	Bolt, Bell Housing to Case - Torx Plus® (Pack)	M10	82-On	1	8 Bolt Pack
54B	057338	24205272	Molded Piston, Forward Clutch		97-On	1	
55B	057337	24205273	Molded Piston, Overrun Clutch		97-On	1	
56B	057339	24200290	Molded Piston, 3/4 Clutch		97-On	1	
NI	057248S	NA	1/16" Hex Plug	Steel	82-On	AR	
NI	057249	NA	1/8" Hex Plug	Brass	82-On	AR	
NI	057249S	NA	1/8" Hex Plug	Steel	82-On	AR	